

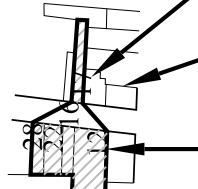





Village of Hamburg Historic Resources Map

Scale: 1" = 500'

KEY

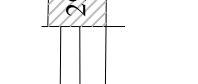
-  Parcel street address
-  Parcel boundary
-  Proposed preservation district boundary
-  Individual property with outstanding architectural and/or historic significance
-  Property possessing above average architectural and/or historic significance
-  Area of 2002 central business district building survey
-  Village line/limit of 2003 field survey

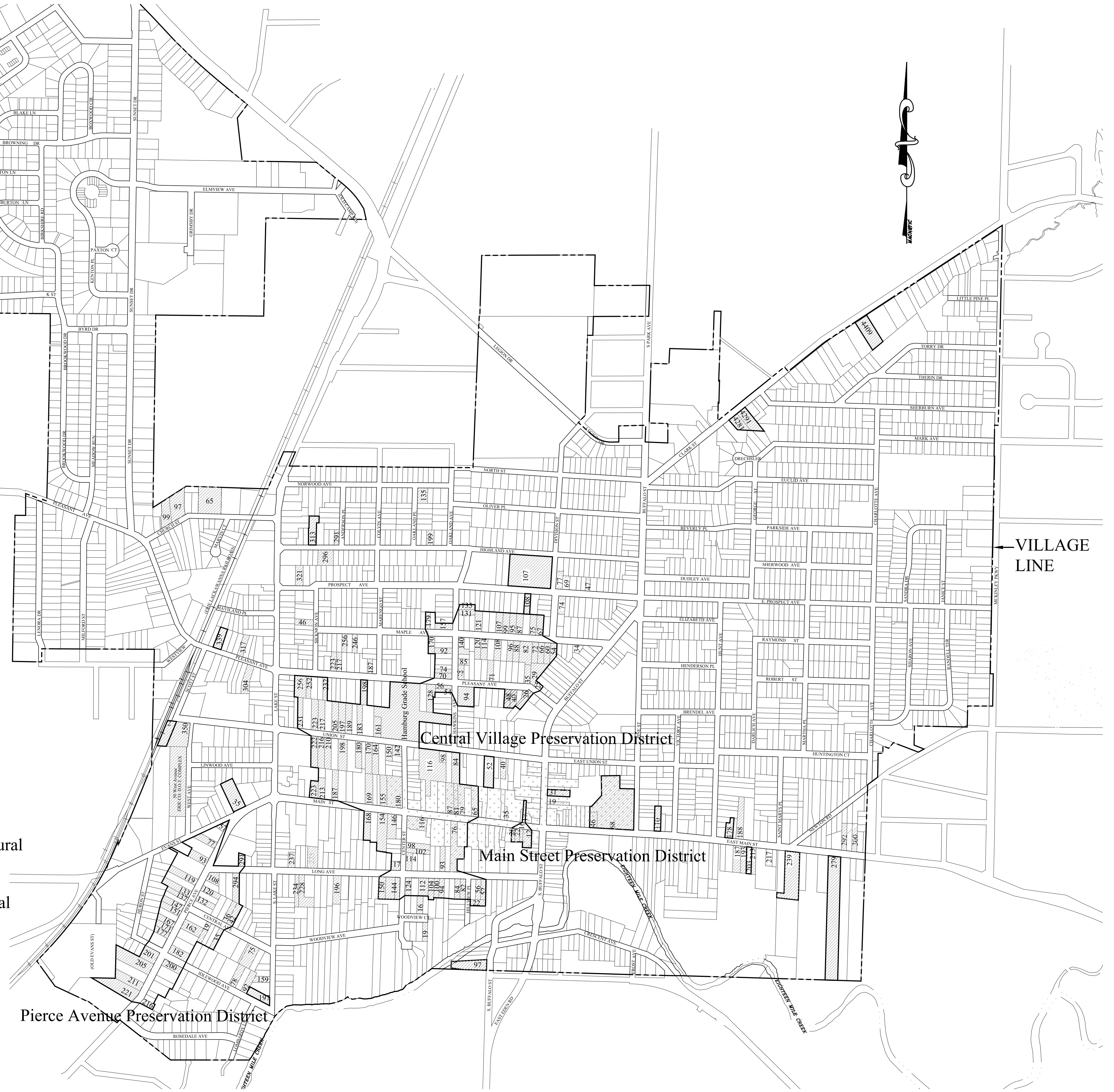

<p>WARNING:</p> <p>This Architectural Drawing is a violation of the Village of Hamburg, New York State laws and regulations which govern the practice of architecture. Any person who uses this drawing for any purpose other than that intended by the architect shall be held liable for any and all consequences thereof. The architect shall not be held responsible for any errors or omissions in this drawing.</p>	<p style="text-align: center;">bero architecture p.c.</p> <p style="text-align: center; font-size: small;">68 Withthrop Street Hoboken, NJ 07030 (201) 261-2000</p>
<p>VILLAGE OF HAMBURG RECONNAISSANCE SURVEY OF HISTORIC RESOURCES</p> <p style="text-align: center; font-size: x-small;">CLIENT/TOWNSHIP VILLAGE OF HAMBURG 100 MAIN STREET HAMBURG, NY 14075</p>	
<p>S-1</p> <p style="font-size: x-small;">April 2004</p> <p style="font-size: x-small;">PROJECT NO. 02141</p>	